

USER MANUAL

EN

Alb Filter® **MOBIL/TRAVEL**

Water filter for the treatment of drinking water in mobile environments.



Blaufaktor GmbH & Co. KG
Riedweg 12
D-78607 Talheim

www.alb-filter.com
info@alb-filter.com

Thank you for purchasing an **Alb Filter® MOBIL/TRAVEL**





To ensure proper installation and efficient operation of the filter, please follow these installation instructions. The step-by-step instructions cover the Alb Filter® products listed below and will walk you through the installation process individually for your product. If necessary, skip information that is not relevant to you.

- » **Mobil Active**
- » **Mobil Nano**
- » **Mobil Fusion**

- » **Travel Active**
- » **Travel Nano**
- » **Travel Fusion**

- » **Pro Camper Set**

MEANING OF PICTOGRAMS

-  Increased attention required
-  Additional information
-  Note
-  Tool required
-  Purchase additionally

TABEL OF CONTENT

Scope of delivery	6
Components Alb Filter® MOBIL and TRAVEL	11
First steps - ACTIVE and NANO	14
First steps - FUSION	16
Connect to water source - MOBIL	20
ACTIVE Filter Cartridge Activation - ACTIVE and FUSION	20
Installing the NANO cartridge - MOBIL and TRAVEL FUSION	22
Connect with water storage tank - MOBIL	23
Installation in camper van - TRAVEL	24
ACTIVE cartridge activation - TRAVEL ACTIVE and FUSION	26
Inserting the NANO cartridge - TRAVEL FUSION	27
Structure and functionality - PRO CAMPER Set	28
Installation wall mount - PRO CAMPER Set	30
Alb Filter® PROTECT	32
Installation Alb Filter® PROTECT	33
Filter cartridge change - ACTIVE and NANO	34
Filter cartridge change ACTIVE - FUSION	36
Filter cartridge change NANO - FUSION	38
Filter cartridges for MOBIL und TRAVEL	40
Cartridge change interval	40
Maintenance and care	41
Technical information	42
Flowcharts	44
FAQ – Frequently asked questions	46
General safety instructions	50
Reminder to change cartridge and cartridge subscription service	52

PREAMBLE

Alb Filter® - a matter of heart.
We are pleased that you have chosen Alb filter.

Since 2001 we can look back on a great experience in the field of water treatment.

At a time when even the smallest part seems to come from the Far East, we at Alb Filter stand for quality from the centre of the Swabian Alb. A production site in southern Germany, which is characterized by the highest standards and precision in many areas.

We feel committed to our region and manufacture our products with our partners in the surrounding area.

A real piece of home - **Made in Germany.**



DESCRIPTION

Alb Filter® MOBIL and TRAVEL sets - high quality water filters for the treatment of water in mobile environments.

The Alb Filter® MOBIL sets - for refueling from outside. The Set are connected directly to a water source via hose. Thanks to our food-safe GEKA® couplings, our filters are compatible with all your GARDENA® products.

The Alb Filter® TRAVEL sets - for fixed installation in the caravan. The Sets are permanently installed behind the tank and filter every drop of water directly before it is drawn off.

Depending on the area of application, you can choose between the **ACTIVE, NANO or FUSION** versions of our Alb Filter® sets. Optionally, all sets can be equipped with the PROTECT pre-filter module to remove coarse impurities from the water in advance to protect the following cartridges.

SCOPE OF DELIVERY

- Note:** Before commissioning, please check that the delivery is complete. **Compare the components of the product you have purchased with the respective list on the following pages.**

The **ACTIVE** and **NANO** sets differ only in the filter cartridge used (Active or Nano). The **FUSION** is a combination of both filter cartridges for full filter performance. The **PRO CAMPER** set includes both filter stages, but separately. The first filter stage (MOBIL ACTIVE) is used during the filling process, while the second stage (TRAVEL NANO) is used behind the tank or short before the fitting.

Additional accessories as well as individual replacement filter cartridges (also available as a subscription) and thread adapters can be found at: www.alb-filter.com

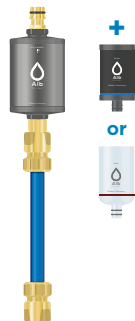

MOBIL – ACTIVE or NANO

- 1x Alb Filter® ELEMENT housing
- 2x GEKA® hose connector (DVGW)
- 1x GEKA® tap plug (DVGW)
- 1x GEKA® device plug (DVGW)
- 1x Quartzflex® drinking water hose, 30 cm (DVGW/KTW)

ACTIVE

- 1x Alb Filter® ACTIVE filter cartridge

NANO

- 1x Alb Filter® NANO filter cartridge

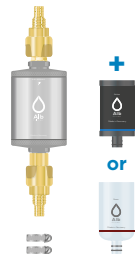

TRAVEL – ACTIVE or NANO

- 1x Alb Filter® ELEMENT housing
- 2x GEKA® hose connector (DVGW)
10 - 13 mm stepped grommet + waterstop
- 1x GEKA® tap plug (DVGW)
- 1x GEKA® device plug (DVGW)
- 2x hose clamps

ACTIVE

- 1x Alb Filter® ACTIVE filter cartridge

NANO

- 1x Alb Filter® NANO filter cartridge



MOBIL FUSION

- 2x Alb Filter® ELEMENT housing
- 1x Alb Filter® ACTIVE filter cartridge
- 1x Alb Filter® NANO filter cartridge
- 1x Alb Filter® CONNECT module
- 2x GEKA®-hose connector (DVGW)
- 1x GEKA® tap plug (DVGW)
- 1x GEKA® device plug (DVGW)
- 1x Quarzflex® drinking water hose, 30 cm (DVGW/KTW)



TRAVEL FUSION

- 2x Alb Filter® ELEMENT housing
- 1x Alb Filter® ACTIVE filter cartridge
- 1x Alb Filter® NANO filter cartridge
- 1x Alb Filter® CONNECT module
- 2x GEKA®-hose connector (DVGW) 10 - 13 mm stepped grommet + waterstop
- 1x GEKA® tap plug (DVGW)
- 1x GEKA® device plug (DVGW)
- 2x hose clamps

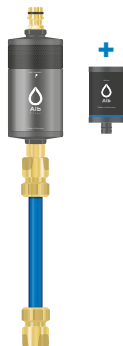

PRO CAMPER SET

- 1x Alb Filter® ELEMENT housing
- 1x Alb Filter® ACTIVE filter cartridge
- 1x Alb Filter® PROTECT incl. Filterpad
- 2x GEKA®-hose connector (DVGW)
- 1x GEKA® tap plug (DVGW)
- 1x GEKA® device plug (DVGW)
- 1x Quarzflex® drinking water hose, 30 cm (DVGW/KTW)

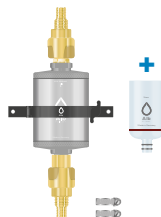

- 1x Alb Filter® ELEMENT housing
- 1x Alb Filter® NANO filter cartridge
- 2x GEKA®-hose connector (DVGW) 10 - 13 mm stepped grommet + waterstop
- 1x GEKA® tap plug (DVGW)
- 1x GEKA® device plug (DVGW)
- 1x Alb Filter® wall mount
- 2x hose clamps

For this set, please follow the installation instructions for Mobil ACTIVE and Travel NANO starting on page 14.

For more information on the PRO CAMPER set, see page 38.

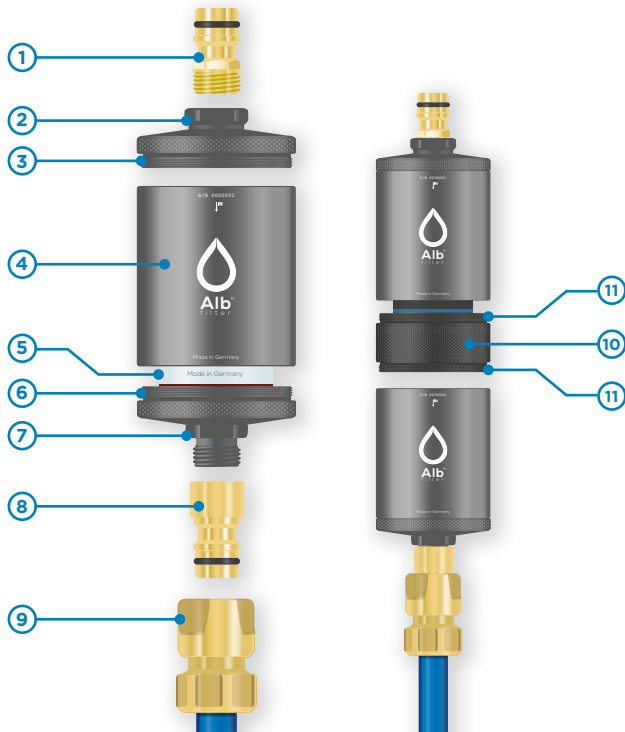

COMPONENTS ALB FILTER® MOBIL

1. GEKA® device plug (DVGW)
2. Top connection (filter inlet): ½-inch female thread with head gasket and 24 mm width across flats for open-end wrench
3. Threaded fitting housing cover
4. Filter body with internal threads and thread protection seal
5. Filter cartridge
6. Threaded fitting housing base
7. Bottom connection (filter outlet): ½-inch male thread with 24 mm width across flats for open-end wrench
8. GEKA® tap plug (DVGW)
9. 2x GEKA® hose connector incl. GEKA® drinking water hose, 30 cm (DVGW/KTW)

Only Alb Filter® MOBIL FUSION

10. Alb Filter® CONNECT module
11. Threaded fitting Alb Filter® CONNECT

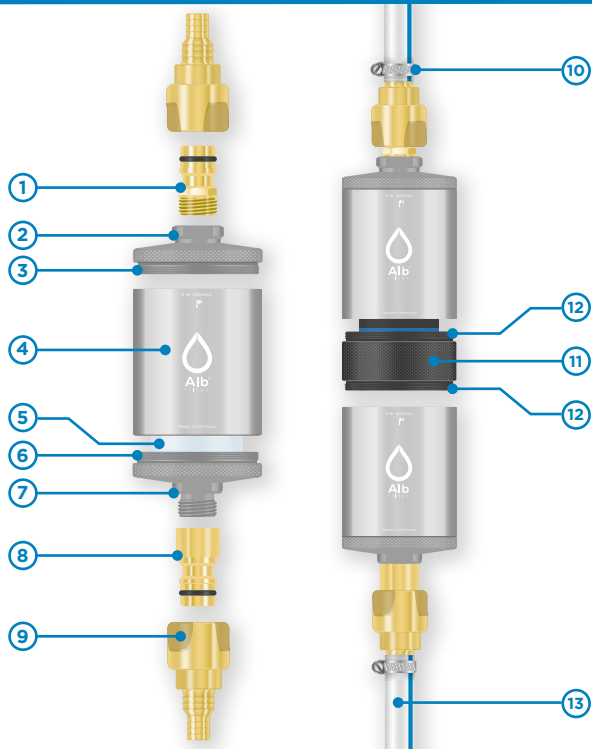

COMPONENTS ALB FILTER® TRAVEL

1. GEKA device plug (DVGW)
2. Top connection (filter inlet): ½-inch female thread with head gasket and 24 mm width across flats for open-end wrench
3. Threaded fitting housing cover
4. Filter body with internal threads and thread protection seal
5. Filter cartridge
6. Threaded fitting housing base
7. Bottom connection (filter outlet): ½-inch male thread with 24 mm width across flats for open-end wrench
8. GEKA® tap plug (DVGW)
9. 2x GEKA® hose connector (DVGW)
10 - 13 mm stepped grommet + waterstop
10. 2x hose clamps

Only Alb Filter® TRAVEL FUSION

11. Alb Filter® CONNECT module
12. Threaded fitting Alb Filter® CONNECT

Not included in set

13. 10 mm or ½-Zoll drinking water hose

FIRST STEPS

(ACTIVE and NANO)

1. Remove the filter body from the packaging.
2. Unscrew the bottom cover of the Alb Filter® ELEMENT from the filter body. **(A)**

✔ The filter cartridge sits in the lower sealing lid with the help of two O-rings (press fit).

3. Press the separately enclosed filter cartridge (ACTIVE or NANO) into the receptacle of the lower sealing lid with slight twisting movements. **(B)**
4. Screw the lower sealing cover back onto the filter body and tighten it hand-firm. **(C)**
5. Screw the GEKA® device plug into the internal thread of the housing cover **(D)** and the GEKA® tap plug to the external thread of the housing base **(E)** and hand-tighten both plugs.

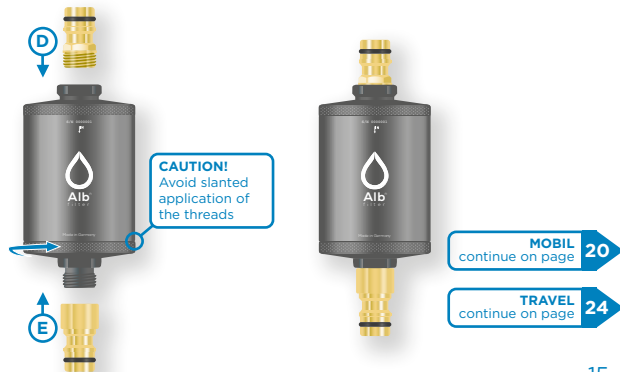
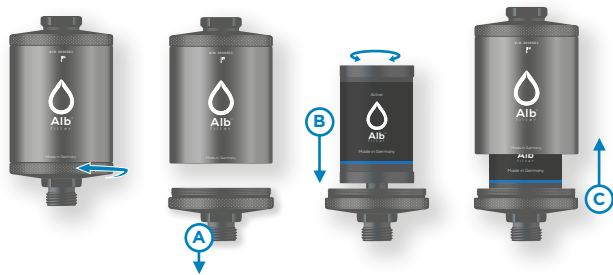

FIRST STEPS (FUSION)

1. Remove both filter housings from the packaging.
2. Unscrew the lower cover of the **upper** ELEMENT housing from the filter body. **(A)**
3. On the **lower** ELEMENT housing, unscrew the upper cover. **(B)**

i Keep the unscrewed caps in a safe place. These are required if you want to use your filters as a PRO CAMPER variant e.g. You can find more info in the FAQ or at www.alb-filter.com

4. Press the ACTIVE filter cartridge with slight twisting movements into the receptacle provided at the Alb Filter® CONNECT module. **(C)**

✓ With the help of two O-rings the filter cartridge is firmly seated in the CONNECT-Modul (press fit).

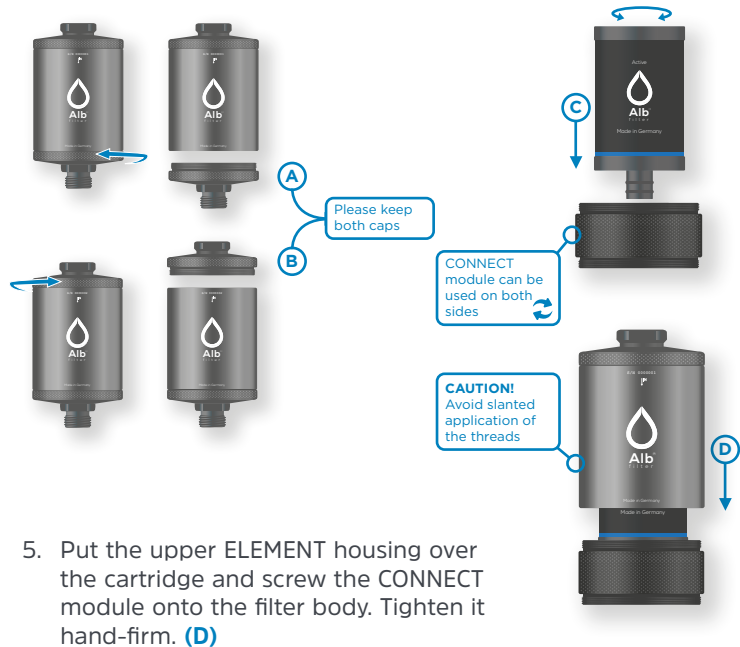

5. Put the upper ELEMENT housing over the cartridge and screw the CONNECT module onto the filter body. Tighten it hand-firm. **(D)**

⚠ Caution: Avoid slanting the union nut on the thread.

6. Screw the lower ELEMENT housing WITHOUT NANO cartridge inside to the lower thread of the CONNECT connection module. **(E)**

⚠ IMPORTANT! The NANO filter cartridge is only inserted after the ACTIVE cartridge has been activated. (Inserting the NANO filter cartridge → page 22)

7. Screw the GEKA device plug into the internal thread of the upper housing cover **(F)** and the GEKA tap plug onto the external thread of the lower housing base **(G)** and hand-tighten both plugs.

i Note: In the water flow direction, the ACTIVE cartridge is located before the NANO cartridge.



CAUTION!
The lower housing remains **empty** for the activation of the ACTIVE cartridge!

TRAVEL
continue on page **24**

CONNECT TO WATER SOURCE (MOBIL)

1. Connect the supplied drinking water hose (incl. hose connector) to the tap connector at the outlet of your filter module. Push back the hose connector union (A) and plug the hose connector incl. hose onto the tap connector. It locks into place with a click. (B)
2. Connect the device connector to any water source in the same way. (C)

i Tap and device plugs are compatible with all GARDENA hose systems. An extension hose to the water source is not included in the scope of delivery (see Fig. C).

ACTIVE FILTER CARTRIDGE ACTIVATION (ACTIVE and FUSION)

3. Carefully open the water supply to activate the cartridge for operation. Let the water run through the filter for 20 seconds.
4. Turn off the water after the activation time.

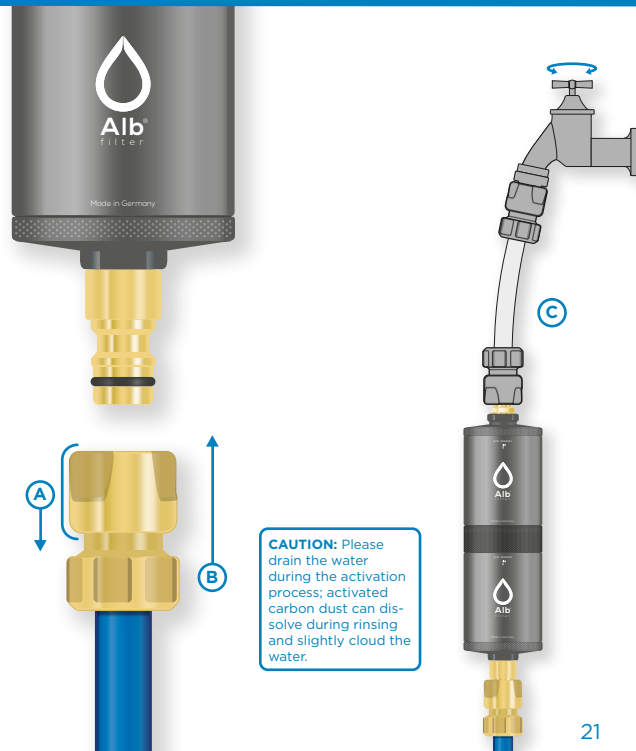

INSTALLING THE NANO CARTRIDGE (MOBIL and TRAVEL FUSION)

- Remove both hoses.
- Unscrew the **lower** sealing cap on the **lower** filter body. **(A)**
- Use slight twisting movements to press the NANO filter cartridge into the receptacle of the sealing lid. **(B)**
- Screw the lower sealing cover back onto the filter body and tighten it hand-firm. **(C)**



CONNECT WITH WATER STORAGE TANK (MOBIL)

- Connect the drinking water hose to your water storage tank (e.g., water tank in caravan). **(D)**
- Check the filter housing and all connected components for leaks.
- Your Alb Filter® MOBIL is now ready for use.

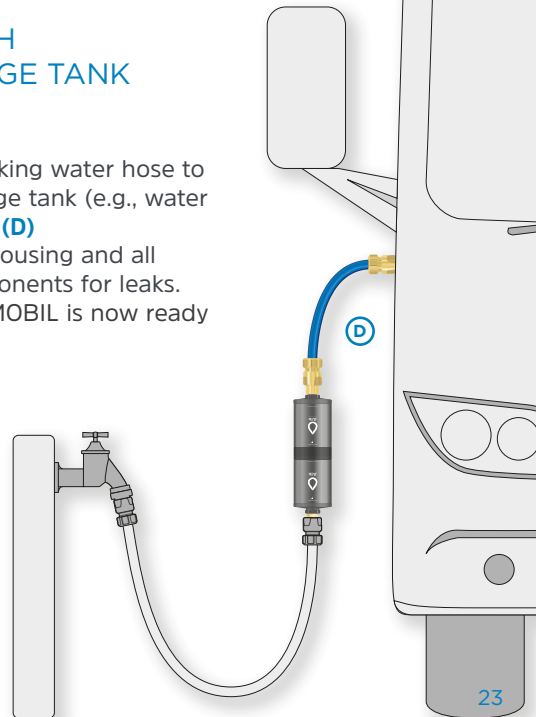

INSTALLATION IN CAMPER VAN (TRAVEL)

1. Find a suitable place to install the Alb Filter® TRAVEL in your camper van (or any other vehicle).

▲ IMPORTANT! Filter installation only **after the pump!**
Make sure the pump is turned off. Open the faucet to release pressure in the system before proceeding.

2. Cut the water hose with a sharp knife. **(A)**
3. Slide one hose clamp over each of the two hose ends. **(B)**
4. Slip the hose (10 - 13 mm inner diameter) as deep as possible over the step grommets of the hose connector **(C)** and slide the hose clamps over it. **(D)**
5. Screw the hose clamps tight by using a suitable tool. **(E)**
6. Connect your filter housing with the two hose connectors by pushing back the union of the hose connector **(F)** and plugging the hose connector onto the tap or device connector. It locks into place with a click. **(G)**
7. The TRAVEL NANO is now ready for use.
8. For TRAVEL ACTIVE and FUSION please continue on next page.

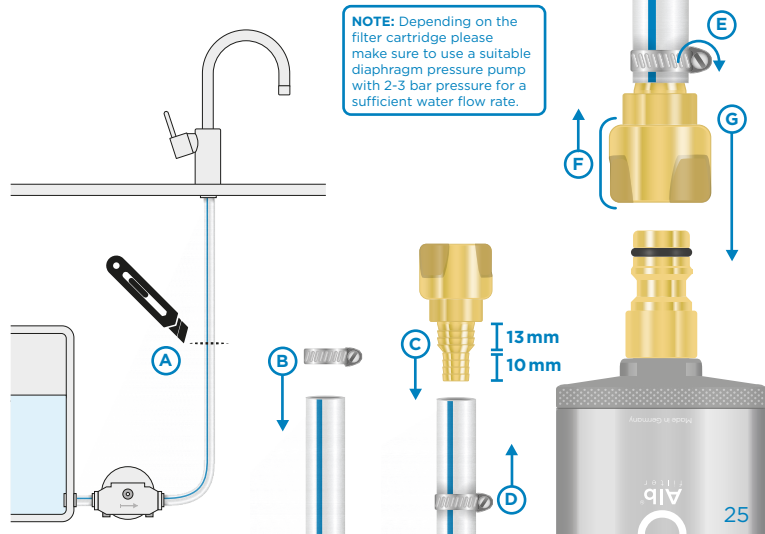

ACTIVE CARTRIDGE ACTIVATION (TRAVEL ACTIVE and FUSION)

⚠ CAUTION WHEN ACTIVATING TRAVEL FUSION: Make sure the NANO cartridge is **not** in the housing during activation process.

9. Carefully open the water supply to activate the cartridge for operation. Let the water run through the filter for 20 seconds.

⚠ Please drain the water during the activation process; activated carbon dust can dissolve during rinsing and slightly cloud the water.

10. Turn off the water after the activation time.

11. The TRAVEL ACTIVE is now ready for use. For the **TRAVEL FUSION**, please refer to page 27.

INSERTING THE NANO CARTRIDGE (TRAVEL FUSION)

12. Turn off the pump and leave the faucet open to relieve pressure in the system. Follow the instructions on page 22 to install the NANO cartridge.

13. After installing the NANO cartridge, reconnect your filter housing to the hose connectors (See 6).

14. Check the filter housing and all connected components for leaks. **(A)**

15. Your Alb Filter® is now ready for use.



STRUCTURE AND FUNCTIONALITY (PRO CAMPER SET)

The PRO CAMPER set combines the advantages of the Alb Filter® MOBIL and TRAVEL. For many campers, this variant has proven to be very practical and reliable.

Stage 1: MOBIL

The MOBIL filter is installed between a water source and the water tank. With a sintered block of activated carbon it filters bad tastes (e.g. chlorine), organic compounds, drug residues, heavy metals and many more. This helps to keep your tank free of sediment, bad odors and non-reproducible organic compounds.

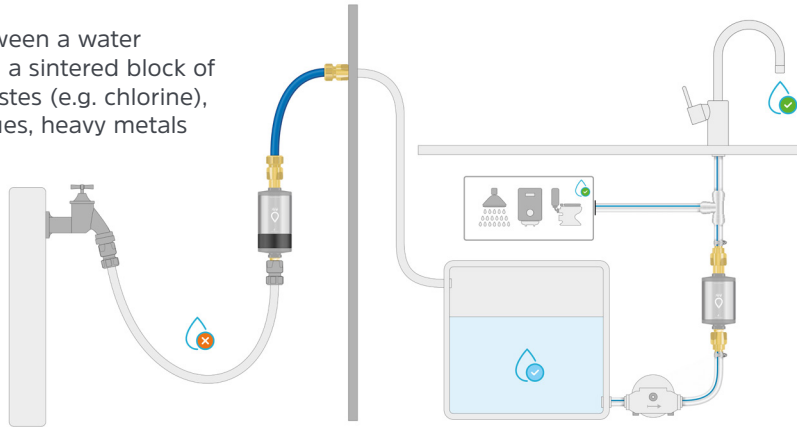

Stage 2: TRAVEL

Short before the water is drawn off, the hollow fiber membrane cartridge inside the TRAVEL filter serves as a germ barrier and manually blocks particles up to 0,1 μm .

Variation 1 (Graphic): The filter can be installed directly after the pump to supply filtered water to all consumers.

Variation 2: If you only prefer to filter your drinking water, you can install the filter short before the tap. Shower, hot water and toilet will not be filtered in this way. This variant is recommended especially for weaker pumps.

INSTALLATION WALL MOUNT (PRO CAMPER Set or available optionally)

✔ While driving, we strongly recommend fixing the TRAVEL filter housing. Use the Alb Filter® wall mount or a comparable product for this purpose. Alb Filter® accepts no liability for damage caused by an unfixed filter.

1. Open the wall bracket fastener and place it around the filter housing. **(A)**
2. Use a pencil to mark the two holes to be drilled on the wall, floor or ceiling. **(B)**
3. Remove the wall bracket and pre-drill the holes.

⚠ To avoid damage to the filter housing, we recommend removing the housing during the drilling process.

4. Firmly fix the bracket to the wall, floor or ceiling with two screws.

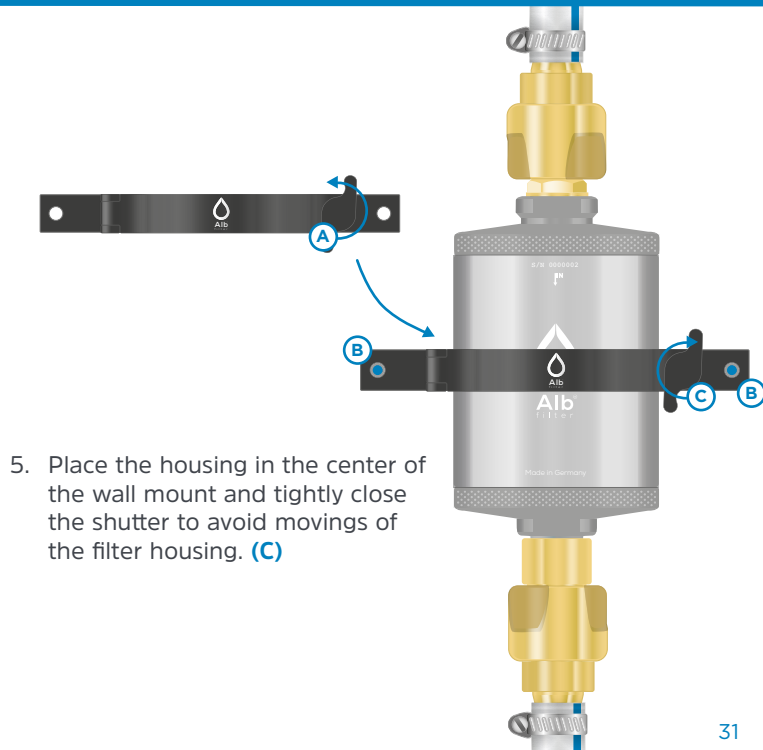

ALB FILTER® PROTECT (PRO CAMPER Set or available optionally)

Pre-filter extension for the ELEMENT housing against coarse impurities.

The add-on module for the Alb Filter® ELEMENT protects your filter cartridges against sediments, sand, rust and coarser particles that can occur due to pipe deposits e.g.

With a porosity of 40 µm and a high flow rate, the PROTECT pre-filter module provides excellent protection and extends the service life of following filter cartridges.



INSTALLATION ALB FILTER® PROTECT

1. Counterclockwise unscrew the **top cover** from the filter body.

i No matter which set you use, the Alb Filter® Protect is always installed at the very top in the direction of water flow to protect the following cartridges.

2. Screw the Protect module - including filter pad and sealing ring - onto the housing.
3. Screw the top cover back onto the filter body.

✓ Pay attention to correctly arrange all necessary parts during installation:
1 Upper sealing cap, **2** Sealing ring, **3** White filter pad, **4** Protect module, **5** Filter housing.

FILTER CARTRIDGE CHANGE (ACTIVE and NANO)

1. Remove both hoses.
2. Unscrew the lower sealing cap on the filter body. **(A)**

 If the sealing cap is stuck, please use a 24 mm open-end wrench. Use a cloth to avoid scratching the housing.

3. With the help of two O-rings the filter cartridge is firmly seated in the lower sealing cap (press fit).

4. With a slight twisting motion pull the filter cartridge out of the lower sealing cap. **(B)**
5. With slight twisting movements press the new filter cartridge into the receptacle of the lower sealing lid. **(C)**
6. Screw the lower sealing cover onto the filter body and tighten it hand-firm. **(D)**
7. Reconnect the hoses.

7. ACTIVE CARTRIDGE ONLY: Let water run through the filter for 20 seconds to activate the cartridge.

 Activated carbon dust can dissolve during rinsing and slightly cloud the water at the beginning of the activation process.

8. Your Alb Filter® is now ready for use again.

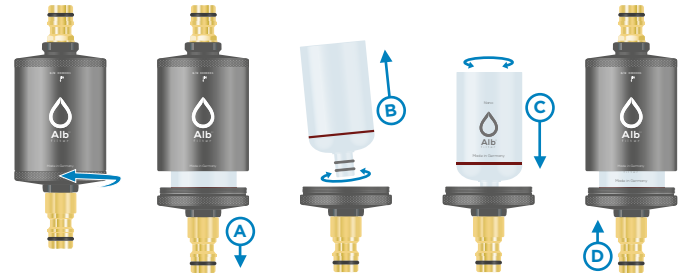

FILTER CARTRIDGE CHANGE ACTIVE (FUSION)

1. Remove both hoses.
2. Unscrew the upper filter housing from the CONNECT module. **(A)**

✔ With the help of two O-rings the filter cartridge is firmly seated in the connection module (press fit).

3. With a slight twisting motion pull the ACTIVE filter cartridge out of the CONNECT module. **(B)**
4. With slight twisting movements press the new filter cartridge into the receptacle of the CONNECT module. **(C)**
5. Screw the filter housing back onto the CONNECT module and tighten it hand-firm **(D)**
6. **Remove** the NANO cartridge in the **lower** housing to activate the ACTIVE cartridge. (Instructions see p. 24)
7. Reconnect the hoses.
8. Let water run through the filter for 20 seconds to activate the ACTIVE cartridge .

❗ Activated carbon dust can dissolve during rinsing and slightly cloud the water at the beginning of the activation process.

9. Reinstall the NANO cartridge in the lower filter housing.
10. Your Alb Filter® FUSION is now ready for use again.



FILTER CARTRIDGE CHANGE NANO (FUSION)

1. Remove both hoses.
2. Unscrew the lower sealing cap on the lower filter body.

(A)

🔧 If the sealing cap is stuck, please use a 24 mm open-end wrench. Use a cloth to avoid scratching the housing.

✔ With the help of two O-rings the filter cartridge is firmly seated in the lower sealing cap (press fit).

3. With a slight twisting motion pull the NANO filter cartridge out of the lower sealing cap. **(B)**
4. With slight twisting movements press the new filter cartridge into the receptacle of the lower sealing lid. **(C)**
5. Screw the lower sealing cover onto the filter body and tighten it hand-firm. **(D)**
6. Reconnect the hoses.
7. Your Alb Filter® is now ready for use again.

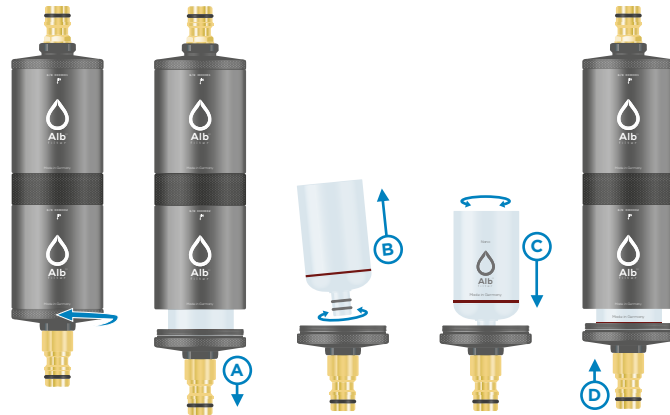

FILTER CARTRIDGES FOR MOBIL UND TRAVEL

Depending on which MOBIL or TRAVEL set you use, the following filter cartridges are being used:



ACTIVE and/or NANO

Further information on the respective filter cartridges can be found on our website at www.alb-filter.com and in the documentation belonging to the filter cartridge.

CARTRIDGE CHANGE INTERVAL

We recommend changing the ACTIVE filter cartridges every four months and the NANO filter cartridges every six months. For further information, please refer to the FAQ (frequently asked questions). Please follow these instructions to not void warranty claims.

Please dispose used filter cartridges in the residual waste.

MAINTENANCE AND CARE

The Alb Filter® MOBIL and TRAVEL sets are basically low-maintenance. However, the maximum service life of the filter cartridges must be observed.

To extend the service life, we recommend removing the cartridge from the housing and drying it completely when not in use. Store the cartridge in a cool (< 4 °C) and dry environment. CAUTION: do not freeze!

To remove calcification, we recommend the use of phosphoric acid or amidosulfonic acid (coffee machine descaler).

Depending on the water quality, it may be necessary to remove any deposits that have formed inside the housing every three weeks by using a kitchen towel, for example.

When changing the filter cartridges, we recommend applying a food-safe lubricant (e.g. Ballistol) to the threads. This keeps the screw connections running smoothly.

TECHNICAL INFORMATION

- **MOBIL Version:** Water filter system for filling the water tank from the outside.
- **TRAVEL Version:** Water filter system for fixed installation behind the water tank.
- **Material:** special alloy, anodized, food safe.
- **Cartridge and capacity:** depending on the selected version
- **Connection inlet (housing cover on top):** ½-inch female thread
- **Connection outlet (bottom of housing):** ½-inch male thread
- **Flow rate:** approx. 5-11 l/min. - depending on cartridge type (at approx. 2-3 bar water pressure)
- **ELEMENT dimensions B x H:** 69 x 125 mm
- **Weight without cartridge:** approx. 450 g



Dimensions Alb Filter® TRAVEL

Please note the space requirement for your permanently installed Alb Filter TRAVEL model. Here you will find the dimensions of the TRAVEL models including the tap and device connectors as well as the two hose connectors.

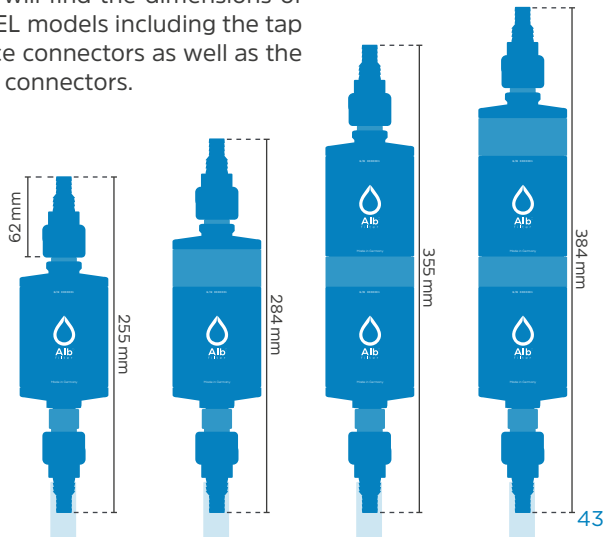

FLOWCHARTS

Charts show approximate values. The flow rate may vary slightly depending on the batch and installation situation.
Values measured with new cartridges.

Active filter cartridge

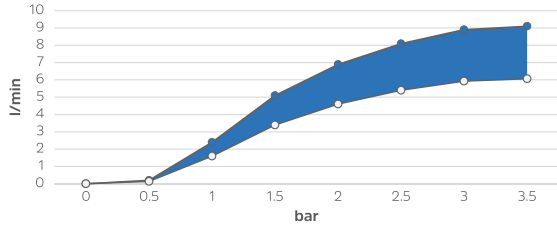

Nano filter cartridge

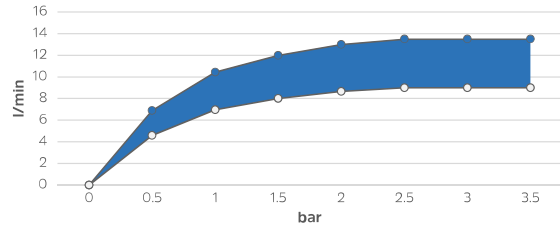

Alb Filter Fusion

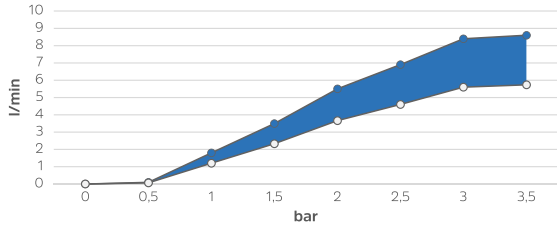

Alb Filter Fusion + Protect

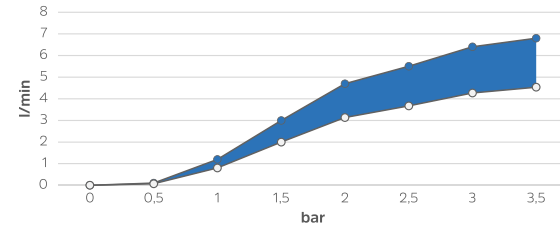

FAQ – FREQUENTLY ASKED QUESTIONS

Q What is the flow rate of the Alb Filter® FUSION?

A The flow rate is based on the ACTIVE cartridge. Due to its fine activated carbon profile, it allows less water to pass through than the NANO filter. See flow charts on previous page and on our website.

Q What does the NANO cartridge filter?

A The NANO cartridge filters solids substances as well as germs and bacteria down to a size of 0.1 µm. This corresponds to 99.9999 % (log6) of microorganisms harmful to humans.

Q Does active carbonate germinates?

A Yes. Please pay attention to the specified service life of the cartridges.

Q How does the filter cartridges need to be stored?

A After activating the cartridges, they must be flushed regularly when not in use. To extend the service life, we recommend removing the cartridge from the housing and drying it completely when not in use. Store the cartridge in a cool (< 4 °C) and dry environment. CAUTION: do not freeze!

Q When does the filter cartridges need to be changed?

A The ACTIVE cartridge should be changed the latest after 4 months, the NANO cartridge after 6 months - at a consumption of approx. 150 l/week. If the flow rate of the cartridge decreases prematurely, this may be due to poor input water quality. In this case the service life of the cartridges can be extended with a pre-filter (e.g. Alb Filter® PROTECT pre-filter module).

Q Are there any signs that a filter change is needed?

A NANO: The water flow is greatly reduced or no water comes through at all.
ACTIVE: The flow rate decreases only in rare cases. Therefore, it is important that the ACTIVE cartridge is changed at regular intervals, at the latest after 4 months or 3,000 l of water flow.

Q How high does the water pressure needs to be for a proper operation of the filter cartridges,?

A ACTIVE: For a good flow the pressure should be 2.3 to 2.6 bar.
NANO: With an unused NANO cartridge, approx. 1 bar is already sufficient for a good flow. Due to clogging of the pores, the required pressure increases over the service life.

Q Does activated carbon filters lime?

A No, the Alb Filter® is not explicitly a lime filter - it filters bound lime flakes, but not dissolved calcium carbonate.

Q Why is only one water hose supplied with the MOBIL set?

A Most campers are usually already equipped with a water hose system. All MOBIL sets are equipped with GEKA hose connectors which are 100% compatible to the Gardena connection system. We offer water hoses and other accessories in our store.

Q May the NANO filter be backwashed?

A Since backwashing voids the warranty, we do not recommend it. CAUTION: Backwashing may damage the fine membranes, which means the original protective function is no longer given.

Q Can you filter water from lakes, rivers and wells?

A Sediment-laden water can severely impair the filter performance. In these cases we always recommend the use of the Alb Filter® PROTECT to filter coarse substances such as sand and sediments in advance. However, there are chemical compounds from industry and agriculture that do not fall within the filter spectrum of our filters, e.g. nitrate!

Q Is it possible to install the filter at home?

A Yes. The housing can be used both as a drinking water filter and a shower filter. The installation takes a few minutes. Instructions can be found on our website: www.alb-filter.com/installation

Q Do I have to fix my Alb Filter® TRAVEL while driving?

A While driving we strongly recommend to fix all Alb Filter® TRAVEL models either with the Alb Filter® wall mount or a comparable product. Alb Filter® accepts no liability for damage caused by a non-fixed filter.

GENERAL SAFETY INSTRUCTIONS

- Delivery includes the filter cartridge selected when ordering. The cartridge is not pre-installed.
- All installation work may only be carried out by a suitably trained specialist. Ensure correct installation of the water inlet and outlet.
- No liability will be accepted for any damage caused if the installation is not carried out correctly.
- Protect from frost.
- The cartridge should be replaced after 4-6 months. However, observe the separately stated replacement interval of the respective cartridge.
- Premature replacement may be necessary if the water flow is visibly reduced or the water quality deteriorates.
- Premature replacement is not a defect of the cartridge used, but an indication of increased occurrence of fine particles in the unfiltered water.
- In exceptional cases, condensation water may form on the filter housing if the water in the supply line is very cold (for physical reasons).
- To ensure complete safety with regard to the quality of your filtered water, a water test in a competent laboratory is mandatory.
- In connection with pressureless boilers it should be noted that due to the high fineness of the cartridge, a pressure is built up in front of it (approximately equal to the mains pressure), which is reduced only slowly. Under certain circumstances, this can lead to damage to the non-pressure-resistant boiler. Contact your responsible plumber for this.
- Please observe the applicable drinking water regulations of your respective country before installation and commissioning.
- Use only with drinking water.

REMINDER TO CHANGE THE FILTER CARTRIDGE

We will gladly remind you to change your filter cartridge. Use our convenient e-mail reminder service:

www.alb-filter.com/reminder

Alternatively, note the date of the first use of your cartridge in this table. Observe the information on the cartridge change interval on page 40.

Start	End	Note

 Replacement cartridges available at www.alb-filter.com
Shop category: Replacement cartridges

CARTRIDGE SUBSCRIPTION SERVICE

Protects the environment and your wallet! With our cartridge abonnement, the replacement cartridge is guaranteed to be delivered to you on time.

To set up the cartridge abonnement, go to www.alb-filter.com under **Shop - Replacement cartridges**.

Select the filter cartridge, go to „Purchase options“ and click on „Save subscription“.

Place the cartridge abonnement in the shopping cart and complete the order.



▶ USER MANUAL ONLINE
www.alb-filter.com/manuals



© 2022
Blaufaktor GmbH & Co. KG
Riedweg 12
78607 Talheim
Deutschland
www.alb-filter.com
info@alb-filter.com

All rights reserved. No part of this manual may be reproduced in any form or copied or processed by any electronic, mechanical or chemical means without the written permission of the publisher.

It is possible that this manual still contains typographical defects or printing errors. However, the information in this manual will be checked regularly and corrections will be made in the next edition. We accept no liability for errors of a technical or printing nature and their consequences.

All trademarks and industrial property rights are acknowledged. Changes in the sense of technical progress can be made without prior notice. Illustrations and diagrams are not binding. All brand and product names used are only to illustrate the compatibility of our products with certain products of various other manufacturers and are the property of the respective owner.

CAMPING V1.2 ENG (11/2022)

Alb Filter® is a trademark of Blaufaktor GmbH & Co. KG registered in the European Union.
Geka® is a trademark of Karasto Armaturenfabrik Oehler GmbH registered in the European Union.
Gardena® is a trademark of Husqvarna AB registered in the European Union.
Quarzflex® is a trademark of Quarzflex GmbH registered in Germany.

